

A side-view photograph of a FourStar Golf Cruiser, a three-wheeled motorized golf cart. The cart is primarily orange and silver, with a blue seat and a black steering column. It is parked on a green golf course with trees in the background. The text "Golf Cruiser" is printed on the orange side panel.

FourStar

Golf Cruiser

USER'S MANUAL

WMI CE ISO9001:2000

CONTENTS

Warnings.....	1
Riding Safety Tips.....	2
Technical Specification.....	3
Technical Description.....	4
Before Riding.....	5
Cleaning & Maintenance.....	9
Recharge.....	10
Troubleshooting.....	11
Packing List.....	12

WARNINGS

Prior to operating the vehicle, carefully read this User's Manual in order to get acquainted with its operational characteristics and safe and proper operation.

NO modification of the vehicle, stripping-off any parts or installing non-original spare parts is permitted.

Be a responsible rider in order to protect yourself and others.

Obey all enforced federal and state laws and be aware of others.

Never ride under the influence of drugs, alcohol and other substances that may influence your riding capabilities.

Use genuine parts and only authorized dealers for your parts and service needs.

■ RIDING SAFETY TIPS

Riding a golf cruiser is simple, yet it requires some skills and experience which can only be accumulated progressively . Prior to each ride, observe the following rules:

1. Check the proper functioning of all vehicle assemblies.
2. Slow down speed when you are turning .
3. Do not overload the golf cruiser, as it may impair the efficiency of the braking system.

■ TECHNICAL SPECIFICATION

Model: GOLF CRUISER

Motor: 1000W

Drive: chain drive

Wheels: front and rear wheel 13inched

Dimensions: 133X76X56CM

N. W.: 106KG

G. W.: 124KG

Battery: 40AH(12V 20AHX6)

Charge Time: 6 Hours, please use timer supplied

Brake: rear hydraulic disc brake

Time-lapse: slow acceleration to protect driver

Low voltage: protection of design



■ TECHNICAL DESCRIPTION



■ BEFORE DRIVING



1. Assemble front 2 wheels



2. Assemble T bar



3. Assemble suspension



4. Tighten foot rest



5. Tighten golf bag holder (Max. Load 15KG), tighten Screw 1 and Screw 2
Make sure the fixing screw engages into the threaded hole.



6. Tighten the basket, and umbrella holder and score card.
Umbrella holder and score card are optional parts.

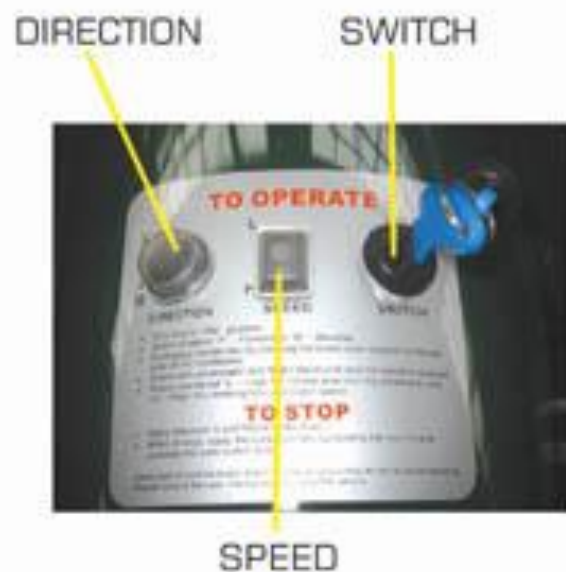

OPERATE PANEL

1. Turn key to "ON" position.
2. Select direction "F" -Forward or "R" - reverse
3. Disengage handbrake by pressing the brake lever situated on the left side of the handlebars.
4. Slowly turn accelerator with right hand until desired speed is obtained
5. Power can be set "L" -low, for normal level running conditions and "H"-high,for climbing hills and faster speed.



BATTERY INDICATOR:

The power light red shows the SWITCH in "ON" position .
Make sure you check the batteries when driving. If green full light = full battery, yellow low light = low battery, this means the batteries need to be recharged.

■ HYDRAULIC BRAKE



The handbrake is located on the left hand side, and includes a press button parking break, which can be adjusted by means of the adjustment screw.

When the parking break is applied, the power to the motor is automatically cut off (for safety).



■ **CLEANING & MAINTENANCE**

1. The golf cruiser should be dried after use and stored in a dry place.
2. The frame and chassis should be wiped over with a lightly oiled cloth.
3. Prior to use, make sure all nuts, bolts and screws are tight.
4. Check the tyre pressure, front tyres should be 0.12-0.14Mpa, rear tyre should be 0.16-0.18Mpa.
5. Grease the chain regularly and maintain no more than 15mm of movement.
6. Grease the steering system regularly.

■ **BATTERY MAINTENANCE**

Always fully charge your battery before store it.

You must fully recharge your battery at least once of every 30days if you have to store it for a long period.

Store your battery in a dry place and the temperature is between 10°C and 30°C.

■ BATTERY RECHARGE

When you find the batteries are low, you should recharge before using. This normally takes 8-10 hours to recharge.

1. Use correct charger according to your local power standard.
(For the charge status you can get detailed instruction in the charger bag.)
2. The battery may require replacement after approximately 250 recharges.



1. Unscrew the fast release rear suspension.

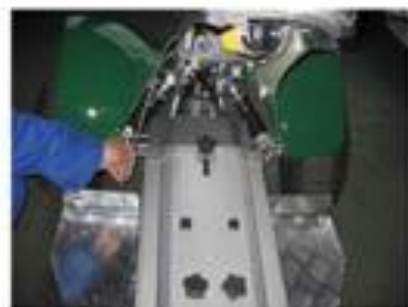

2. Attach the suspension arm to the magnet point.



3. Unscrew the two screws and open the battery case, disconnect the two charger plugs.



4. Take out battery for recharge, or they can be charged in golf cruiser.

■ TROUBLESHOOTING

Problem	Check	Solution
Can not drive	1. Check that the key is turned to the "ON" position.	1. When the key is turned to the "ON" position, you will hear a click.
	2. Check that the parking break button has been released.	2. The golf cruiser will now operate.
	3. Check the circuit breaker has not triped out. This is located under the main body.	3. Check if all wiring connectors are correctly fitted, then reset the circuit breaker.
	4. If the "Change Direction Switch" has been inadvertently changed whilst in motion.	4. Stop golf cruiser, release throttle and restart.

* Find the circuit diagram in the plastic body .

■ PACKING LIST

SX-E0906-2A

NAME	SPECS	QTY	NAME	SPECS	QTY
Golf cruiser		1 PC	Controller fuse		2 PCS
Bag holder	Max Load 15KG	1 PC	Tools kit	5A	1 SET
Basket		1 PC			
User's manual		1 PC			
Charger	36V 4A	1 PC			

■ OPTIONAL PARTS



Carrying frame



Front mud guard



Rain cover



Score card



Umbrella holder

Contact your local distributor:

New Zealand Importer - Electric Vehicles Enzed

www.electricvehiclesenzed.co.nz

0800 000 605

Canterbury Dealer - More Mobility

www.moremobility.co.nz

0800 666 222

Otago & Southland Dealer - Mobility Scooters Otago

www.mobilityscooters.co.nz

0800 566 800

New Zealand Nation Wide Service Agents

Battery Mart Dealers

www.batterymart.co.nz

0800 24 50 24 for your closest dealer

Thank you for choosing Golf Cruiser!
Enjoy your golf !

Distributor: